

SECTION F

ENGINE MOUNTING
CYLINDER BLOCK
TAPPET INSPECTION COVER
TIMING CHAIN CASE AND TENSIONER
PISTONS
CONNECTING RODS
CRANKSHAFT
CRANKSHAFT MAIN BEARINGS
FLYWHEEL
CAMSHAFT
CAMSHAFT BEARINGS
TIMING CHAIN
CYLINDER HEAD
ROCKER GEAR
PUSH-ROD ASSEMBLY
TAPPETS
MANIFOLDS

DESCRIPTION	No. off per Car	Commencing Engine No. XPAG/TD501		Part No.	Commencing Engine No.	Part No.	Commencing Engine No.	REMARKS
		Part No.	Illus. No.					
POWER UNIT AND MOUNTING								
Power unit complete (with gear-box, etc.)	1	XPAG/TD		XPAG/TD2	9408			
Half-engine	1	SA2449		SA2449/1				
Power unit with clutch (less gear-box), electrical equipment, carburettors, and manifolds	1	SA2445		SA2445/1				
Mounting rubber—engine—front	1	I39513	F1					
Engine control link (L/H thread)	1	I26855	F2					
Cup—link	2	ACA5379	F3					
Link cup rubber	2	I26858	F4					
Adjuster	1	I26853	F5					
Engine control bracket	1	I36281	F6					
Packing washer	2	I26861						
Rear engine bearer bracket	1	I36180	G1					
Support rubber	2	I39514	G2					
Fork end	1	I26867	G3					
Engine rebound rubber	1	I26868	G4					
Clevis pin—fork end	1	81199	G5					
Cup—link	1	ACA5379	G6					
Bracket—control link	1	X24190						
Washer for control link bracket	1	PNN105						
Control link (R/H thread)	1	I26854						
Link cup rubber	2	I26858						
CYLINDER BLOCK, MAIN BEARING CAP, AND TAPPET COVER								
Cylinder block complete (with main bearing caps and pistons)	1	SA2404/9	F7	SA2404/10	9404	AEG5	17969	Prior to Engine No. 2985 the following parts must also be supplied: X24446, CA1122, LA7155, 31605, X24448, X24447, CA1283
Cylinder liner—66.5 mm.	4	301603						
Core plug—large	2	X21406						
Core plug—small	6	CA1056						
Core plug—camshaft	1	X15002						
Plug—oil gallery—front	1	X22732						
Plug—oil gallery—rear	1	X15393						
Plug—oil feed hole	5	X22968	F8					
Plug—oil hole—by-pass	1	X20247	F9					
Plug for oil hole by-pass	1			168121	9404			
Main bearing cap—front	1	X22715	J1					
Main bearing cap—centre	1	X22716	J2					
Main bearing cap—rear (with pipe)	1	SA2250	J3					
Pipe—rear cap	1	X22748	J4					
Seal—rear cap	1	X22432	J79					
Dowel cap	3	X22515						
Bearing cap studs	6	LA7104						
Nuts—bearing cap	6	CA1043	J5					
Studs—cylinder head	10	X20014	F13					
Stud—water pump—long	1	JB5968	K2					
Stud—tappet cover	3	X22331	F16					
Dowel—clutch housing	2	X15016	H17					
Stud—water pump	1	X20167	K1					
Oil seal cover	1	X22517	F10					
Gasket—oil seal cover	1	X22518	F11					
Bolt—cover	3	JA5384	F12					
Spring washer bolt	3	CA1282						
Dowel cover	2	X21044						
Water drain tap	1	3H2724	F14					
Washer—drain tap	1	JA5411	F15					
Guide—oil level indicator	1	X24408						
Screw—engine number-plate	1	AEC3202						

DESCRIPTION	No. off per Car	Commencing Engine No. XPAG/TD501		Part No.	Commencing Engine No.	Part No.	Commencing Engine No.	REMARKS
		Part No.	Illus. No.					
PISTONS, CONNECTING RODS, AND BEARINGS								
Pistons complete (with rings and gudgeon pins)	4	SA2418/2	J10					
Piston ring—compression	8	X24009	J11					
Piston ring—oil control	4	X24010	J12					
Gudgeon pin	4	X24103	J13					
Connecting rod with caps and bolts	4	SA2405	J14					
Bolt—connecting rod cap	8	X24006	J15					
Nut—connecting rod cap bolt	8	AEF131	J16					
Clamp screw—gudgeon pin	4	CA1009	J17					
Spring washer—clamp screw	4	CA1283	J18					
Bearing—big-end—standard	set	AJG4003	J23					
Bearing—big-end—012" U/S	set	AJG400312						
Bearing—big-end—020" U/S	set	AJG400320						
Bearing—big-end—030" U/S	set	AJG400330						
Bearing—big-end—040" U/S	set	AJG400340						
CRANKSHAFT MAIN BEARINGS AND FLYWHEEL								
Crankshaft complete (with main bearings)	1	168632	J19					
Bush—crankshaft (clutch spligot)	1	AMK804						
Bearing—standard	set	AJG4002	J20, 21, 22					
Bearing—012" O/S	set	AJG400212						
Bearing—020" O/S	set	AJG400220						
Bearing—030" U/S	set	AJG400230						
Bearing—040" U/S	set	AJG400240						
Bearing—050" U/S	set	AJG400250						
Flywheel (with starter ring and dowels) (R)	1	SA2252/1	H18	SA2252/2	9408			
Starter ring	1	X24418		168020				
Dowel—clutch cover	2	AEG3101	H19					
Dowel—crankshaft	2	X22947	H20					
Bolt—flywheel securing	4	TA13079	H61					
Oil thrower—crankshaft	1	X15027	J24					
Chain sprocket	1	X22742	J25					
Key—chain sprocket	1	JA5255	J26					
Pulley (on crankshaft)	1	X24093	J27					
Key—crankshaft pulley	1	JA5255	J28					
Washer	1	X15424	J29					
Nut—crankshaft	1	X15029	J30					
Shim—nut (.125 mm.)	A/R	AEC765	J31					
CAMSHAFT BEARINGS AND TIMING CHAIN								
Camshaft	1	X24084	J32	168553	24116			When supplying Pt. No. 168553 supply also 168729
Chain sprocket	1	X22744	J33					
Key—chain sprocket	1	JA5255	J34					
Bolt—camshaft	1	X24120	J35					
Washer—chain sprocket	1	X22540	J36					
Lock washer—chain sprocket	1	X22324	J37					
Oil thrower—camshaft	1	X22702	J38					
Circlip—camshaft—rear	1	X22733	J39					
Thrust plate—camshaft	1	X22543	J40					

DESCRIPTION	No. off per Car	Commencing Engine No. XPAG/TD501		Part No.	Commencing Engine No.	Part No.	Commencing Engine No.	REMARKS	
		Part No.	Illus. No.						
Camshaft Bearings and Timing Chain—continued									
Bolt—thrust plate	2	X15175							
Spring washer—thrust plate bolt	2	CA1282							
Bearing—camshaft—front	1	X22542	J41						
Bearing—camshaft—rear	1	X22546	J42						
Bearing—camshaft—intermediate	1	SA2224/2	J43						
Screwed dowel—bearing	2	X22547	J44						
Plain dowel—bearing	2	X21044	J45						
Timing chain	1	X22571	J46						
AMENDMENTS									
CYLINDER HEAD AND VALVE GEAR									
Cylinder head assembly complete with valves and rocker gear	1	SA2203/7		SA2203/10	22735				
Cylinder head (studded) with guides	1	SA2204/7	F45	SA2204/11					
Stud—cover	2	X21027	F46						
Stud—manifold	4	X24063	F47						
Valve guide—inlet	4	X22549	J47						
Valve guide—exhaust	4	X22551	J47						
Push-rod cover tubes	8	X22339							
Core plug—cylinder head	4	CA1614							
Plug—oil hole	1	X15188							
Valve—inlet	4	X22548	J48						
Valve—exhaust	4	X22550	J48	168387	18291				
Spring—valve—inner	8	X24069	J49						
Spring—valve—outer	8	X24068	J50						
Cap—spring—bottom	8	X24090	J51						
Oil deflector valve	8	X24086	J52						
Cap—spring—top	8	X22788	J53						
Packing ring—valve	8	AEK113	J54						
Split cotters—valve spring	16	X20081	J55	168374	9408				
Support bracket—rocker shaft (front, intermediate, and rear)	4	X22914	J56						
Bolt—support bracket (8 mm.)	4	X22915	J57						
Bolt—support bracket (10 mm.)	4	X22755	J58						
Lock plate—support bracket bolts	4	X22916	J59						
Washer—Nos. 1 and 4 brackets	2	X22917	J60						
Washer—Nos. 2 and 3 brackets	2	X22758	J61						
Rocker shaft with plugs	1	SA2232/1 ✓	J62	SA2232/2	9008				
Plug—rocker shaft	2	X15188	J63						
Spacer spring—long—centre	1	X20428	J64						
Spacer spring—medium outer	2/1	X20429	J65					1 off comm. 9008	
Spacer spring—short—front and rear	2/4	X19216	J66					4 off comm. 9008	
Spring clip—rocker shaft	2	X20048	J67						
Washer—spring clip	2/10	X20128	J68					10 off comm. 9008	
Valve rocker with bush (Nos. 4 and 8 valves)	2	SA2213/4	J69	SA2213/5	9008				
Valve rocker with bush (Nos. 1 and 5 valves)	2	SA2214/4	J70	SA2214/5					
Bush for valve rocker (Nos. 4, 8, 1, and 5 valves)	4	X22700	J71	X20036					

KEY TO PLATE F

Illus. No.	Description	Page No.
F1	Mounting rubber—engine—front	F.2
F2	Engine control link (L/H thread)	F.2
F3	Cup—link	F.2
F4	Link cup rubber	F.2
F5	Adjuster	F.2
F6	Engine control bracket	F.2
F7	Cylinder block complete	F.2
F8	Plug—oil feed hole	F.2
F9	Plug—oil hole—by-pass	F.2
F10	Oil seal cover	F.2
F11	Gasket—oil seal cover	F.2
F12	Bolt—cover	F.2
F13	Studs—cylinder head	F.2
F14	Water drain tap	F.2
F15	Washer—drain tap	F.2
F16	Stud—tappet cover	F.2
F17	Tappet inspection cover	F.3
F18	Joint—cover	F.3
F19	Nut—cover stud	F.3
F20	Washer—cover stud	F.3
F21	Breather pipe	F.3
F22	Bracket—breather pipe	F.3
F23	Bolt—breather pipe bracket	F.3
F24	Nut—breather pipe bracket	F.3
F25	Clip—breather pipe	F.3
F26	Bolt—breather pipe clip	F.3
F27	Nut—clip bolt	F.3
F28	Spring—oil filter—by-pass	F.3
F29	Ball—oil filter—by-pass	F.3
F30	Guide—ball	F.3
F31	Seat—ball	F.3
F32	Timing chaincase assembly	F.3
F33	Packing—chaincase	F.3
F34	Joint—chaincase to plate	F.3
F35	Bolt—long—chaincase to block	F.3
F36	Bolt—short—chaincase to block	F.3
F37	Bearer plate—front	F.3
F38	Joint—plate to block	F.3
F39	Bolt—plate to case	F.3
F40	Bolt—plate to block	F.3
F41	Bracket—plate	F.3
F42	Bolt—bracket	F.3
F43	Nut	F.3
F44	Spring washer	F.3
F45	Cylinder head (studded) with guides	F.5
F46	Stud—cover	F.5
F47	Stud—manifold	F.5
F48	Rear cover—cylinder head	F.6
F49	Joint—rear cover—plate	F.6
F50	Screw—rear cover—plate	F.6
F51	Water outlet pipe (studded)	F.6
F52	Stud—thermostat	F.6
F53	Bolt—water outlet pipe	F.6
F54	Joint—water outlet pipe	F.6
F55	Gasket—cylinder head	F.6
F56	Nut—securing cylinder head	F.6
F57	Cylinder head cover assembly	F.6
F58	Oil filler cap	F.6
F59	Joint—cylinder head cover	F.6
F60	Nut—cylinder head cover	F.6
F61	Washer—cylinder head cover	F.6
F62	Stud—exhaust manifold flange	F.6
F63	Nut—stud	F.6
F64	Joint—exhaust manifold	F.6
F65	Clamp—exhaust manifold	F.6
F66	Nut—exhaust manifold clamp	F.6
F67	Oil sump	G.2
F68	Drain plug—sump	G.2
F69	Washer—drain plug	G.2

Illus. No.	Description	Page No.
F70	Plug—oil hole	G.2
F71	Packing	G.2
F72	Joint—sump to block	G.2
F73	Bolt—sump—front	G.2
F74	Bolt—sump—short	G.2
F75	Bolt—sump—long	G.2
F76	Dipstick	G.2
F77	Suction filter assembly	G.2
F78	Filter gauze	G.2
F79	Spring—oil suction pipe	G.2
F80	Fibre washer	G.2
F81	Washer	G.2
F82	Joint—flange	G.2
F83	Bolt	G.2
F84	Oil pipe assembly—pump to filter	G.2
F85	Oil pump assembly—filter to block	G.2
F86	Bolt—banjo	G.2
F87	Washer—small	G.2
F88	Washer—large	G.2
F89	Oil filter	G.2
F90	Support bracket for oil filter	G.2
F91	Bolt—bracket	G.2
F92	Strap—oil filter bracket	G.2
F93	Bolt—strap	G.2
F94	Oil pump—bushed	G.2
F95	Bush—oil pump—body	G.2
F96	Oil pump cover with valve seat	G.2
F97	Bolt—cover—long	G.3
F98	Bolt—cover—medium	G.3
F99	Bolt—cover—short	G.3
F100	Lock washer	G.3
F101	Oil pump shaft and gear	G.3
F102	Gear—driving	G.3
F103	Key—driving gear	G.3
F104	Circlip—driving gear	G.3
F105	Oil pump gear (driven) with bush	G.3
F106	Bush—oil pump gear	G.3
F107	Spindle—driven gear	G.3
F108	Guide—relief valve ball	G.3
F109	Relief valve ball	G.3
F110	Spring—relief valve	G.3
F111	Cover plug—relief valve	G.3
F112	Washer—cover plug	G.3
F113	Joint—oil pump body	G.3
F114	Oil pipe—gallery to head	G.3
F115	Screw—banjo to head	G.3
F116	Screw—banjo to block	G.3
F117	Washer—screw	G.3
F118	Bracket—engine control link	G.4
F119	Engine control link (R/H thread)	G.4
F120	Rubber bush	G.4
F121	Cup washer	G.4
F122	Air cleaner	J.2
F123	Clip—air cleaner	J.2
F124	Wing nut—air cleaner stud	J.2
F125	Breather hose—air cleaner	J.2
F126	Clip—breather hose	J.2
F127	Pipe to air cleaner	J.2
F128	Joint—pipe to carburetter	J.2
F129	Bracket—dynamo	K.2
F130	Bolt—dynamo bracket	K.2
F131	Swivel bolt—short—dynamo	K.2
F132	Adjusting link	K.2
F133	Bolt—link	K.2
F134	Nut—swivel bolt	K.2
F135	Pulley—dynamo	K.2
F136	Flexible connection—oil gauge	K.3
F137	Connector—oil pipe	K.4

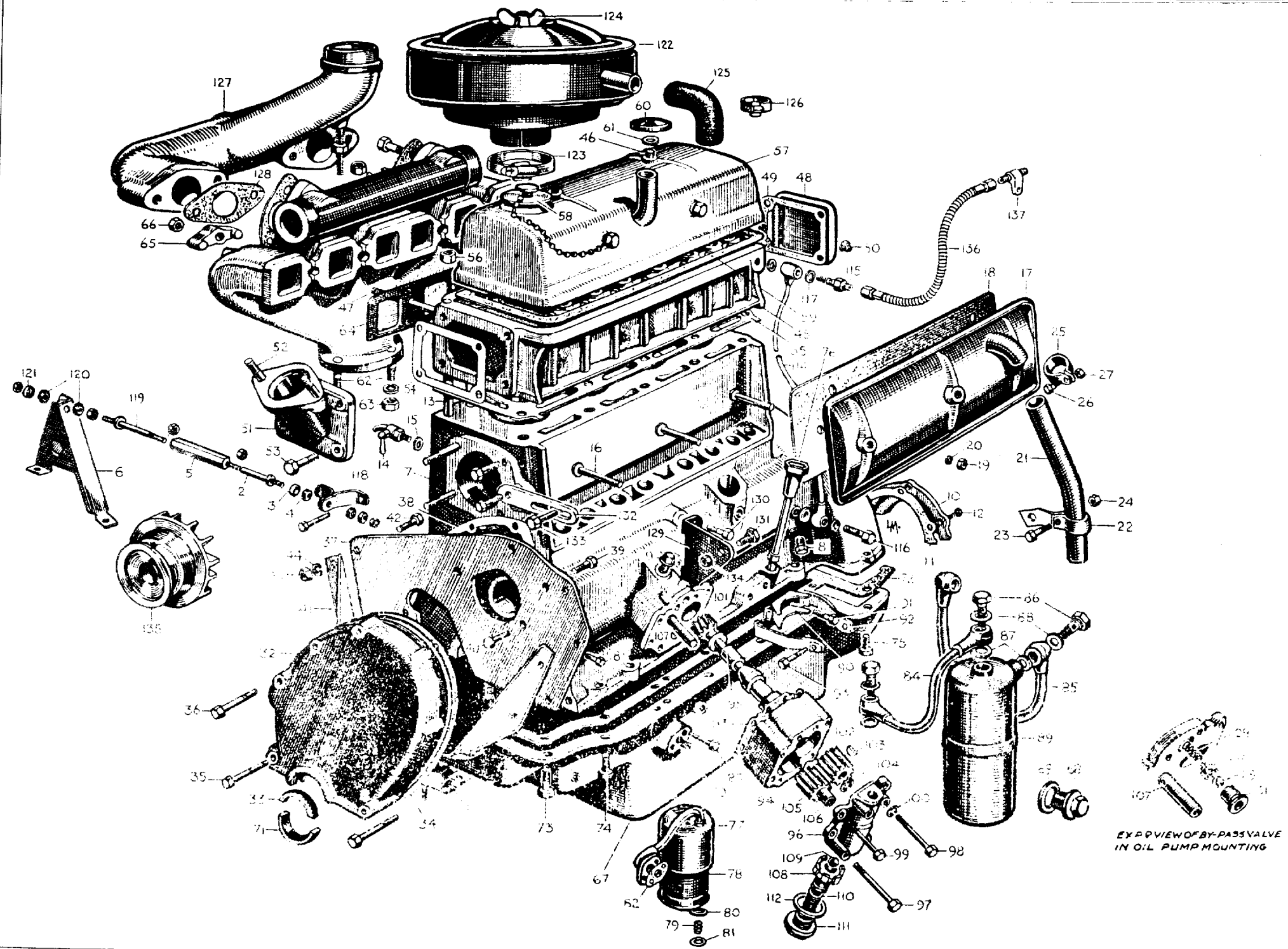

EXP. VIEW OF BY-PASS VALVE IN O.I.L. PUMP MOUNTING

KEY TO PLATE G

Illus. No.	Description	Page No.
G1	Rear engine bearer bracket	F.2
G2	Support rubber	F.2
G3	Fork end	F.2
G4	Engine rebound rubber.....	F.2
G5	Clevis pin—fork end	F.2
G6	Washer	F.2
G7	Gearbox casing (with studs)	H.2
G8	Stud—gearbox top cover	H.2
G9	Stud—speedometer casing—medium	H.2
G10	Stud—speedometer casing—long	H.2
G11	Stud—speedometer casing—short	H.2
G12	Plug—oil drain	H.2
G13	Washer—drain plug	H.2
G14	Oil level indicator	H.2
G15	Mainshaft	H.2
G16	Mainshaft bearing	H.2
G17	Circlip—mainshaft bearing	H.2
G18	Guard—bearing—first motion shaft	H.3
G19	Plate guard	H.3
G20	Spring plate—guard	H.3
G21	Striking dog	H.3
G22	Sliding hub assembly (top and third)	H.3
G23	Spring—sliding hub	H.3
G24	Ball—spring	H.3
G25	Third speed gear	H.3
G26	Rollers—third speed gear	H.3
G27	Collar—third speed gear	H.3
G28	Plunger—third speed gear	H.3
G29	Spring—plunger	H.3
G30	Second speed gear	H.3
G31	Rollers—second speed gear	H.3
G32	Washer—second speed gear	H.3
G33	Collar—second speed gear	H.3
G34	Plunger—second speed gear	H.3
G35	Spring plunger	H.3
G36	Sliding hub (first and second)	H.3
G37	First speed gear	H.3
G38	Spring—first speed gear	H.3
G39	Ball—spring	H.3
G40	Circlip	H.3
G41	Distance-piece	H.3
G42	Layshaft	H.3
G43	Gear unit—layshaft	H.3
G44	Rollers—layshaft gear unit	H.3
G45	Spacer—layshaft gear unit.....	H.3
G46	Washer—layshaft	H.3
G47	Thrust washer—front	H.3
G48	Thrust washer—rear	H.3
G49	Bearing plate—front	H.3
G50	Bearing plate—rear	H.3
G51	Screw	H.3
G52	First motion shaft	H.3
G53	Bearing—first motion shaft	H.3
G54	Circlip—first motion shaft	H.3
G55	Guard—bearing—first motion shaft	H.3
G56	Nut—first motion shaft bearing	H.3
G57	Lock washer—bearing	H.3
G58	Spigot bearing rollers	H.3
G59	Oil seal—first motion shaft	H.3
G60	Reverse gear (with bush)	H.3
G61	Shaft—reverse gear	H.3
G62	Plug—reverse shaft	H.3
G63	Screw—reverse shaft	H.3
G64	Top and third gear selector	H.3
G65	Locating screw—selector.....	H.3
G66	Top and third gear shifter	H.3

Illus. No.	Description	Page No.
G67	Locating screw—shifter	H.3
G68	Distance tube—top and third	H.4
G69	Shaft—top and third shifter	H.4
G70	First and second gear shifter	H.4
G71	Locating screw	H.4
G72	First and second gear selector	H.4
G73	Locating screw	H.4
G74	Shaft—first and second shifter	H.4
G75	Stop—shaft	H.4
G76	Locating screw—stop	H.4
G77	Reverse gear selector	H.4
G78	Plunger—reverse gear selector	H.4
G79	Spring—plunger	H.4
G80	Ball—reverse plunger	H.4
G81	Spring—ball	H.4
G82	Locating screw	H.4
G83	Shaft—reverse selector	H.4
G84	Steady—reverse selector shaft.....	H.4
G85	Locating screw—steady	H.4
G86	Gear shifter reverse—upper	H.4
G87	Gear shifter reverse—lower	H.4
G88	Shaft—reverse gear shifter.....	H.4
G89	Locating screw—shaft	H.4
G90	Reverse link assembly	H.4
G91	Fulcrum pin—link	H.4
G92	Nut—fulcrum pin.....	H.4
G93	Washer—fulcrum pin	H.4
G94	Ball—shaft	H.4
G95	Spring—shifter shaft	H.4
G96	Gearbox cover.....	H.4
G97	Gasket—cover	H.4
G98	Nut—cover	H.4
G99	Filler plug—gearbox	H.4
G100	Washer for plug	H.4
G101	Rear casing	H.4
G102	Nut—rear casing	H.4
G103	Ball bearing	H.4
G104	Guard	H.4
G105	Oil retaining washer	H.4
G106	Hole plug—reverse light.....	H.4
G107	Speedometer gear	H.4
G108	Speedometer pinion	H.4
G109	Bearing—pinion	H.4
G110	Screw—pinion bearing	H.4
G111	Flange—universal joint	H.4
G112	Washer—flange	H.4
G113	Nut—flange to mainshaft.....	H.4
G114	Remote control cover	H.4
G115	Gasket—cover	H.5
G116	Cover bolt to rear casing.....	H.5
G117	Housing cover plunger	H.5
G118	Plug—operating shaft	H.5
G119	Spring—operating shaft	H.5
G120	Remote control shaft	H.5
G121	Selector lever—front	H.5
G122	Selector lever—rear	H.5
G123	Ball—lever	H.5
G124	Key—actuating shaft and selector levers	H.5
G125	Bolt—actuating shaft and selector levers	H.5
G126	Change speed lever	H.5
G127	Knob—change speed lever	H.5
G128	Cover—lever	H.5
G129	Spring—anti-rattle change speed lever	H.5
G130	Circlip—cover	H.5
G131	Circlip—shaft.....	H.4

KEY TO PLATE H

Illus. No.	Description	Page No.
H1	Clutch pedal and bush	D.2
H2	Pad—rubber—clutch pedal	D.2
H3	Pad—brake pedal.....	D.2
H4	Bolt—pad—brake pedal	D.2
H5	Nut—pad bolt	D.2
H6	Shaft—clutch.....	D.2
H7	Seager circlip.....	D.2
H8	Spacing washer between pedals	D.2
H9	Bush—brake pedal.....	D.2
H10	Clutch cable assembly.....	D.2
H11	Nut—clutch adjuster	D.2
H12	Pin—clutch adjuster	D.2
H13	Connecting rod—clutch	D.2
H14	Yoke pin—rod	D.2
H15	Spring—clutch return	D.2
H16	Pin—clutch lever	D.2
H17	Dowel—clutch housing	F.2
H18	Flywheel (with starter ring and dowels)	F.4
H19	Dowel—clutch cover	F.4
H20	Dowel—crankshaft	F.4
H21	Bracket—clutch return spring.....	G.2
H22	Bolt—bracket	G.2
H23	Spring washer—bolt	G.2
H24	Lever—cable and connecting rod	G.2
H25	Bush—lever	G.2
H26	Fulcrum pin—lever	G.2
H27	Nut—fulcrum pin.....	G.2
H28	Washer—fulcrum pin	G.2
H29	Washer—fulcrum pin—outer	G.2
H30	Abutment bracket—clutch cable	G.2
H31	Bolt—bracket	G.2

Illus. No.	Description	Page No.
H32	Cover—clutch	H.2
H33	Release lever—clutch	H.2
H34	Eye-bolt and nut	H.2
H35	Fulcrum pin—release lever	H.2
H36	Strut—release lever	H.2
H37	Spring—anti-rattle—release lever	H.2
H38	Spring—retaining—release lever	H.2
H39	Plate—release lever	H.2
H40	Spring—pressure plate	H.2
H41	Pressure plate—clutch.....	H.2
H42	Clutch release bearing and cup assembly ..	H.2
H43	Retainer—clutch release bearing	H.2
H44	Clutch driven plate assembly	H.2
H45	Rivet—clutch driven plate	H.2
H46	Facing	H.2
H47	Bolt—clutch cover	H.2
H48	Clutch withdrawal shaft	H.2
H49	Circlip—withdrawal shaft	H.2
H50	Fork—clutch	H.2
H51	Key—clutch fork	H.2
H52	Taper pin—clutch fork	H.2
H53	Clutch operating lever	H.2
H54	Key—clutch lever	H.2
H55	Taper pin—clutch lever	H.2
H56	Clutch housing (with bushes)	H.2
H57	Bush—clutch housing	H.2
H58	Bolt—securing clutch housing	H.2
H59	Clutch inspection cover	H.2
H60	Screw—inspection cover	H.2
H61	Bolt—flywheel securing.....	H.4

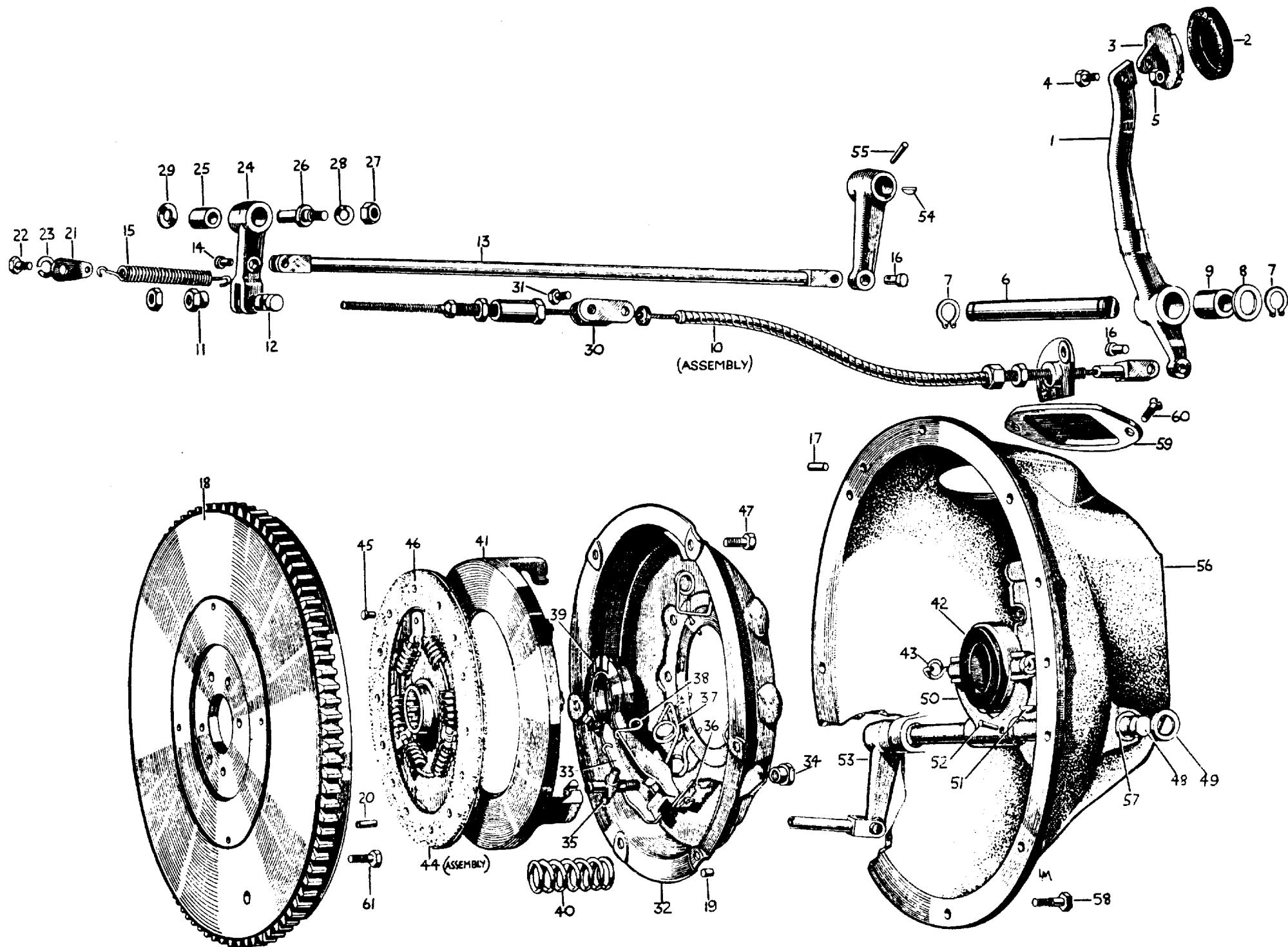

KEY TO PLATE J

Illus. No.	Description	Page No.
J1	Main bearing cap—front	F.2
J2	Main bearing cap—centre	F.2
J3	Main bearing cap—rear	F.2
J4	Pipe—rear cap	F.2
J5	Nuts—bearing cap	F.2
J6	Tensioner—chain	F.3
J7	Feed block—tensioner	F.3
J8	Bolt—feed block.....	F.3
J9	Spring—tensioner	F.3
J10	Piston complete (with rings and gudgeon pins)	F.4
J11	Piston ring—compression	F.4
J12	Piston ring—oil control	F.4
J13	Gudgeon pin	F.4
J14	Connecting rod with caps and bolts	F.4
J15	Bolt—connecting rod cap.....	F.4
J16	Nut—connecting rod cap bolt	F.4
J17	Clamp screw—gudgeon pin	F.4
J18	Spring washer—clamp screw	F.4
J19	Crankshaft complete (with main big-end bearings)	F.4
J20	Bearing—front	F.4
J21	Bearing—intermediate	F.4
J22	Bearing—rear	F.4
J23	Bearing—connecting rod.....	F.4
J24	Oil thrower—crankshaft.....	F.4
J25	Chain sprocket	F.4
J26	Key—chain sprocket	F.4
J27	Pulley—on crankshaft	F.4
J28	Key—crankshaft pulley	F.4
J29	Washer	F.4
J30	Nut—crankshaft	F.4
J31	Shims—nut	F.4
J32	Camshaft	F.4
J33	Chain sprocket	F.4
J34	Key—chain sprocket	F.4
J35	Bolt—camshaft	F.4
J36	Washer—chain sprocket	F.4
J37	Lock washer—chain sprocket	F.4
J38	Oil thrower—camshaft	F.4
J39	Circlip—camshaft—rear.....	F.4
J40	Thrust plate—camshaft	F.4

Illus. No.	Description	Page No.
J41	Bearing—camshaft—front.....	F.5
J42	Bearing—camshaft—rear	F.5
J43	Bearing—camshaft—intermediate	F.5
J44	Screwed dowel—bearing	F.5
J45	Plain dowel—bearing.....	F.5
J46	Timing chain	F.5
J47	Valve guide—inlet and exhaust.....	F.5
J48	Valve—inlet and exhaust	F.5
J49	Spring—valve—inner	F.5
J50	Spring—valve—outer	F.5
J51	Cap—spring—bottom.....	F.5
J52	Oil deflector—valve	F.5
J53	Cap—springs—top	F.5
J54	Packing ring—valve	F.5
J55	Split cotters—valve spring.....	F.5
J56	Support bracket—rocker-shaft.....	F.5
J57	Bolt—support bracket (8 mm.)	F.5
J58	Bolt—support bracket (10 mm.)	F.5
J59	Lock plate—support bracket bolts.....	F.5
J60	Washer—Nos. 1 and 5 brackets.....	F.5
J61	Washer—Nos. 2 and 3 brackets.....	F.5
J62	Rocker-shaft with plugs	F.5
J63	Plug—rocker-shaft	F.5
J64	Spacer spring—long—centre	F.5
J65	Spacer spring—medium—outer	F.5
J66	Spacer spring—short—front and rear	F.5
J67	Spring clip—rocker-shaft	F.5
J68	Washer—spring clip.....	F.5
J69	Valve rocker with bush—Nos. 4 and 8 valves	F.5
J70	Valve rocker with bush—Nos. 1 and 5 valves	F.5
J71	Bush for valve rocker (Nos. 1, 4, 5 and 8 valves)	F.5
J72	Valve rocker with bush (Nos. 2 and 6 valves)	F.6
J73	Valve rocker with bush (Nos. 3 and 7 valves)	F.6
J74	Bush for valve rocker (Nos. 2, 3, 6 and 7 valves)	F.6
J75	Adjusting screw—rocker	F.6
J76	Locknut—adjusting screw	F.6
J77	Push-rod assembly	F.6

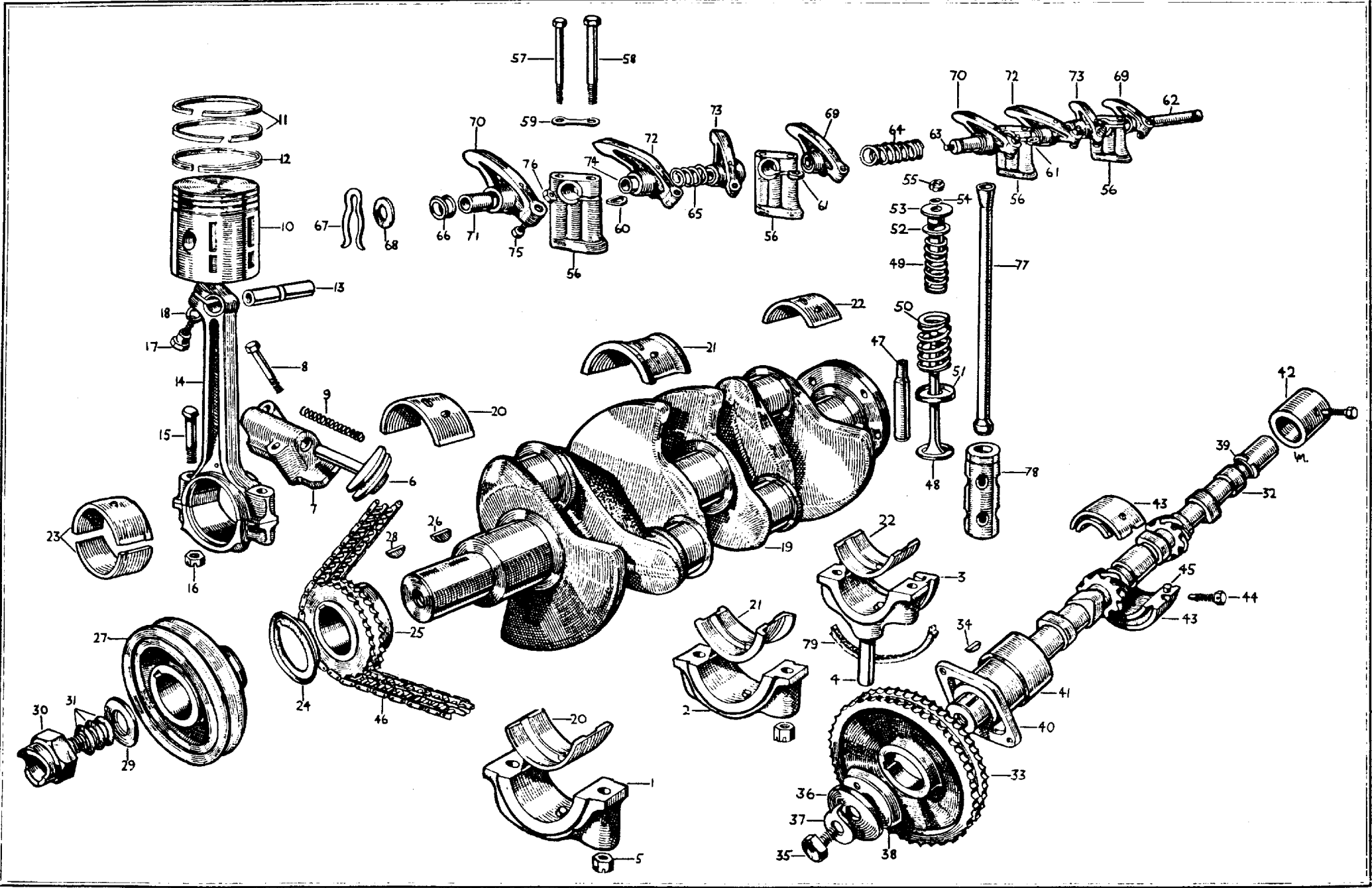

KEY TO PLATE K

Illus. No.	Description	Page No.
K1	Stud—water pump—short	F.2
K2	Stud—water pump—long	F.2
K3	Water pump body	G.3
K4	Spindle—water pump	G.3
K5	Rotor—water pump.....	G.3
K6	Taper pin—rotor	G.3
K7	Nut—spindle	G.3
K8	Washer—spindle	G.3
K9	Fan pulley	G.3
K10	Key—pulley.....	G.3
K11	Grease nipple	G.3
K12	Dust excluder—front	G.3
K13	Cover—front dust excluder	G.3
K14	Bearing—spindle	G.3
K15	Circlip—bearing	G.3
K16	Distance tube—bearing	G.3
K17	Dust excluder—rear—felt	G.3
K18	Cover—dust excluder—centre	G.3
K19	Cover—dust excluder—rear	G.3
K20	Circlip—spindle	G.3

Illus. No.	Description	Page No.
K21	Seal—water pump	G.3
K22	Joint—pump body to block	G.3
K23	Bolt—pump—short	G.3
K24	Nut—water pump bolt	G.3
K25	Bolt—pump—long	G.4
K26	Fan blade	G.4
K27	Fan blade (offset)	G.4
K28	Bolt—fan blade	G.4
K29	Distance-piece	G.4
K30	Drive belt—for fan and dynamo	G.4
K31	Connecting pipe—pump	G.4
K32	Hose—connecting pipe	G.4
K33	Clip (1½" dia.)—connecting pipe	G.4
K34	Thermostat	G.4
K35	Joint—thermostat	G.4
K36	Hose—by-pass pipe	G.4
K37	Clip (1½" dia.)—by-pass hose	G.4
K38	Elbow—thermostat	G.4
K39	Screw—elbow	G.4

THE  MIDGET (SERIES "TD")
FAN AND WATER PUMP

PLATE K

SERVICE PARTS LIST

