

SECTION G



ENGINE OIL SUMP AND DETAILS

ENGINE OIL PUMP AND DETAILS

ENGINE OIL PIPES AND DETAILS

WATER PUMP

FAN

DESCRIPTION	No. off per Car	Commencing Engine No. XPAG/TD501		Part No.	Commencing Engine No.	Part No.	Commencing Engine No.	REMARKS
		Part No.	Illus. No.					
ENGINE OIL SUMP AND OIL PIPE DETAILS								
Oil sump with baffle and drain plug	1	SA2411/4	F67					
Drain plug—sump	1	X15096	F68					
Washer—drain plug	1	AEC699	F69					
Plug—oil hole	1	OA10798	F70					
Washer for oil hole plug	1	LA7417						
Baffle—sump	1	X24392		168243	14948			
Bolt—baffle	4	JA5384						
Spring washer—baffle bolt	4	CA1282						
Packing	1	AEG126	F71					
Joint—sump to block	1	X22724	F72					
Bolt—sump—front	2	X15268	F73					
Bolt—sump—short	10	LA7431	F74					
Bolt—sump—long	2	X15269	F75					
Spring washer—sump bolt	14	X15270						
Bracket—clutch return spring	1	X24202	H21					
Bolt—bracket	1	AJD6205N	H22					
Spring washer—bolt	1	X23194	H23					
Lever—cable and connecting rod	1	SA2436	H24					
Bush—lever	1	QA11682	H25					
Fulcrum pin—lever	1	X24206	H26					
Nut—fulcrum pin	1	X23049	H27					
Washer—fulcrum pin	1	X25138	H28					
Washer—fulcrum pin—outer	1	X24208	H29					
Abutment bracket—clutch cable	1	X24204	H30					
Bolt—bracket	1	AJD6205N	H31					Fin. at 22716
Spring washer—bracket bolt	1	X23054						
Dipstick	1	X24407	F76					
Suction filter assembly	1	168008	F77	168250	15372	168727	26364	
Oil suction pipe	1	168010		168249	15372	168728	26364	
Suction filter spring	1			JA5890				
Washer—suction filter spring	1			X22781				
Filter extension	1			168706				
Washer—filter extension	1			X22767				
Set screw	1			HPS0405				
Lock washer	1			168726	15372			
Gasket	1			X22973				
Bolt for oil filter	2			JA5117				
Spring washer	2			CA1282				
Washer	2			CA1255				
Filter gauze	1	X24294	F78					
Spring—oil suction pipe	1	X22776	F79					Fin. at 15371
Fibre washer	1	X25040	F80					
Washer	1	X22781	F81					
Joint—flange	1	X22773	F82					
Bolt	2	X22780	F83					
Oil pipe assembly (pump to filter)	1	X24451	F84					
Oil pipe assembly (filter to block)	1	X24359	F85					
Bolt—banjo	4	X19089	F86					
Washer—small	4	AEG3122	F87					
Washer—large	4	X19090	F88					Fin. at 14223
Oil filter	1	X22768	F89					
Support bracket for oil filter	1	X24148	F90	X24446	2985			
Bolt—bracket	2	CA1122	F91					
Spring washer	2	CA1283						
Strap—oil filter bracket	2	MG862/445	F92					Fin. at 2984
Strap—oil filter	1	X24443		X24447	2985			
Strap—oil filter	1	X24444		X24448	2985			Fin. at 14223

KEY TO PLATE F

Illus. No.	Description	Page No.
F1	Mounting rubber—engine—front	F.2
F2	Engine control link (L/H thread)	F.2
F3	Cup—link	F.2
F4	Link cup rubber	F.2
F5	Adjuster	F.2
F6	Engine control bracket	F.2
F7	Cylinder block complete	F.2
F8	Plug—oil feed hole	F.2
F9	Plug—oil hole—by-pass	F.2
F10	Oil seal cover	F.2
F11	Gasket—oil seal cover	F.2
F12	Bolt—cover	F.2
F13	Studs—cylinder head	F.2
F14	Water drain tap	F.2
F15	Washer—drain tap	F.2
F16	Stud—tappet cover	F.2
F17	Tappet inspection cover	F.3
F18	Joint—cover	F.3
F19	Nut—cover stud	F.3
F20	Washer—cover stud	F.3
F21	Breather pipe	F.3
F22	Bracket—breather pipe	F.3
F23	Bolt—breather pipe bracket	F.3
F24	Nut—breather pipe bracket	F.3
F25	Clip—breather pipe	F.3
F26	Bolt—breather pipe clip	F.3
F27	Nut—clip bolt	F.3
F28	Spring—oil filter—by-pass	F.3
F29	Ball—oil filter—by-pass	F.3
F30	Guide—ball	F.3
F31	Seat—ball	F.3
F32	Timing chaincase assembly	F.3
F33	Packing—chaincase	F.3
F34	Joint—chaincase to plate	F.3
F35	Bolt—long—chaincase to block	F.3
F36	Bolt—short—chaincase to block	F.3
F37	Bearer plate—front	F.3
F38	Joint—plate to block	F.3
F39	Bolt—plate to case	F.3
F40	Bolt—plate to block	F.3
F41	Bracket—plate	F.3
F42	Bolt—bracket	F.3
F43	Nut	F.3
F44	Spring washer	F.3
F45	Cylinder head (studded) with guides	F.5
F46	Stud—cover	F.5
F47	Stud—manifold	F.5
F48	Rear cover—cylinder head	F.6
F49	Joint—rear cover—plate	F.6
F50	Screw—rear cover—plate	F.6
F51	Water outlet pipe (studded)	F.6
F52	Stud—thermostat	F.6
F53	Bolt—water outlet pipe	F.6
F54	Joint—water outlet pipe	F.6
F55	Gasket—cylinder head	F.6
F56	Nut—securing cylinder head	F.6
F57	Cylinder head cover assembly	F.6
F58	Oil filler cap	F.6
F59	Joint—cylinder head cover	F.6
F60	Nut—cylinder head cover	F.6
F61	Washer—cylinder head cover	F.6
F62	Stud—exhaust manifold flange	F.6
F63	Nut—stud	F.6
F64	Joint—exhaust manifold	F.6
F65	Clamp—exhaust manifold	F.6
F66	Nut—exhaust manifold clamp	F.6
F67	Oil sump	G.2
F68	Drain plug—sump	G.2
F69	Washer—drain plug	G.2

Illus. No.	Description	Page No.
F70	Plug—oil hole	G.2
F71	Packing	G.2
F72	Joint—sump to block	G.2
F73	Bolt—sump—front	G.2
F74	Bolt—sump—short	G.2
F75	Bolt—sump—long	G.2
F76	Dipstick	G.2
F77	Suction filter assembly	G.2
F78	Filter gauze	G.2
F79	Spring—oil suction pipe	G.2
F80	Fibre washer	G.2
F81	Washer	G.2
F82	Joint—flange	G.2
F83	Bolt	G.2
F84	Oil pipe assembly—pump to filter	G.2
F85	Oil pump assembly—filter to block	G.2
F86	Bolt—banjo	G.2
F87	Washer—small	G.2
F88	Washer—large	G.2
F89	Oil filter	G.2
F90	Support bracket for oil filter	G.2
F91	Bolt—bracket	G.2
F92	Strap—oil filter bracket	G.2
F93	Bolt—strap	G.2
F94	Oil pump—bushed	G.2
F95	Bush—oil pump—body	G.2
F96	Oil pump cover with valve seat	G.2
F97	Bolt—cover—long	G.3
F98	Bolt—cover—medium	G.3
F99	Bolt—cover—short	G.3
F100	Lock washer	G.3
F101	Oil pump shaft and gear	G.3
F102	Gear—driving	G.3
F103	Key—driving gear	G.3
F104	Circlip—driving gear	G.3
F105	Oil pump gear (driven) with bush	G.3
F106	Bush—oil pump gear	G.3
F107	Spindle—driven gear	G.3
F108	Guide—relief valve ball	G.3
F109	Relief valve ball	G.3
F110	Spring—relief valve	G.3
F111	Cover plug—relief valve	G.3
F112	Washer—cover plug	G.3
F113	Joint—oil pump body	G.3
F114	Oil pipe—gallery to head	G.3
F115	Screw—banjo to head	G.3
F116	Screw—banjo to block	G.3
F117	Washer—screw	G.3
F118	Bracket—engine control link	G.4
F119	Engine control link (R/H thread)	G.4
F120	Rubber bush	G.4
F121	Cup washer	G.4
F122	Air cleaner	J.2
F123	Clip—air cleaner	J.2
F124	Wing nut—air cleaner stud	J.2
F125	Breather hose—air cleaner	J.2
F126	Clip—breather hose	J.2
F127	Pipe to air cleaner	J.2
F128	Joint—pipe to carburetter	J.2
F129	Bracket—dynamo	K.2
F130	Bolt—dynamo bracket	K.2
F131	Swivel bolt—short—dynamo	K.2
F132	Adjusting link	K.2
F133	Bolt—link	K.2
F134	Nut—swivel bolt	K.2
F135	Pulley—dynamo	K.2
F136	Flexible connection—oil gauge	K.3
F137	Connector—oil pipe	K.4

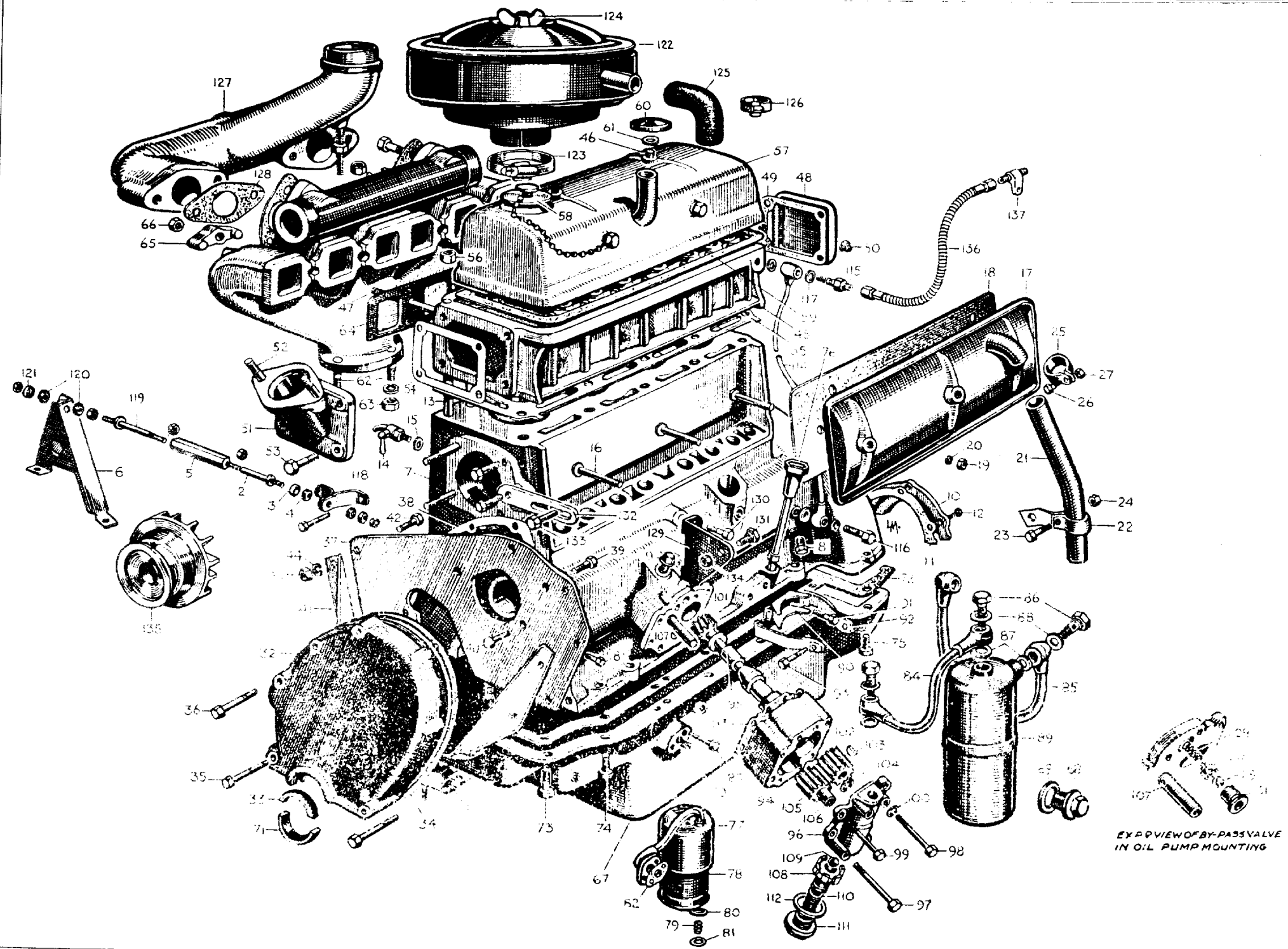

EXP. VIEW OF BY-PASS VALVE IN O.I.L. PUMP MOUNTING

KEY TO PLATE H

Illus. No.	Description	Page No.
H1	Clutch pedal and bush	D.2
H2	Pad—rubber—clutch pedal	D.2
H3	Pad—brake pedal.....	D.2
H4	Bolt—pad—brake pedal	D.2
H5	Nut—pad bolt	D.2
H6	Shaft—clutch.....	D.2
H7	Seager circlip.....	D.2
H8	Spacing washer between pedals	D.2
H9	Bush—brake pedal.....	D.2
H10	Clutch cable assembly.....	D.2
H11	Nut—clutch adjuster	D.2
H12	Pin—clutch adjuster	D.2
H13	Connecting rod—clutch	D.2
H14	Yoke pin—rod	D.2
H15	Spring—clutch return	D.2
H16	Pin—clutch lever	D.2
H17	Dowel—clutch housing	F.2
H18	Flywheel (with starter ring and dowels)	F.4
H19	Dowel—clutch cover	F.4
H20	Dowel—crankshaft	F.4
H21	Bracket—clutch return spring.....	G.2
H22	Bolt—bracket	G.2
H23	Spring washer—bolt	G.2
H24	Lever—cable and connecting rod	G.2
H25	Bush—lever	G.2
H26	Fulcrum pin—lever	G.2
H27	Nut—fulcrum pin.....	G.2
H28	Washer—fulcrum pin	G.2
H29	Washer—fulcrum pin—outer	G.2
H30	Abutment bracket—clutch cable	G.2
H31	Bolt—bracket	G.2

Illus. No.	Description	Page No.
H32	Cover—clutch	H.2
H33	Release lever—clutch	H.2
H34	Eye-bolt and nut	H.2
H35	Fulcrum pin—release lever	H.2
H36	Strut—release lever	H.2
H37	Spring—anti-rattle—release lever	H.2
H38	Spring—retaining—release lever	H.2
H39	Plate—release lever	H.2
H40	Spring—pressure plate	H.2
H41	Pressure plate—clutch.....	H.2
H42	Clutch release bearing and cup assembly ..	H.2
H43	Retainer—clutch release bearing	H.2
H44	Clutch driven plate assembly	H.2
H45	Rivet—clutch driven plate	H.2
H46	Facing	H.2
H47	Bolt—clutch cover	H.2
H48	Clutch withdrawal shaft	H.2
H49	Circlip—withdrawal shaft	H.2
H50	Fork—clutch	H.2
H51	Key—clutch fork	H.2
H52	Taper pin—clutch fork	H.2
H53	Clutch operating lever	H.2
H54	Key—clutch lever	H.2
H55	Taper pin—clutch lever	H.2
H56	Clutch housing (with bushes)	H.2
H57	Bush—clutch housing	H.2
H58	Bolt—securing clutch housing	H.2
H59	Clutch inspection cover	H.2
H60	Screw—inspection cover	H.2
H61	Bolt—flywheel securing.....	H.4

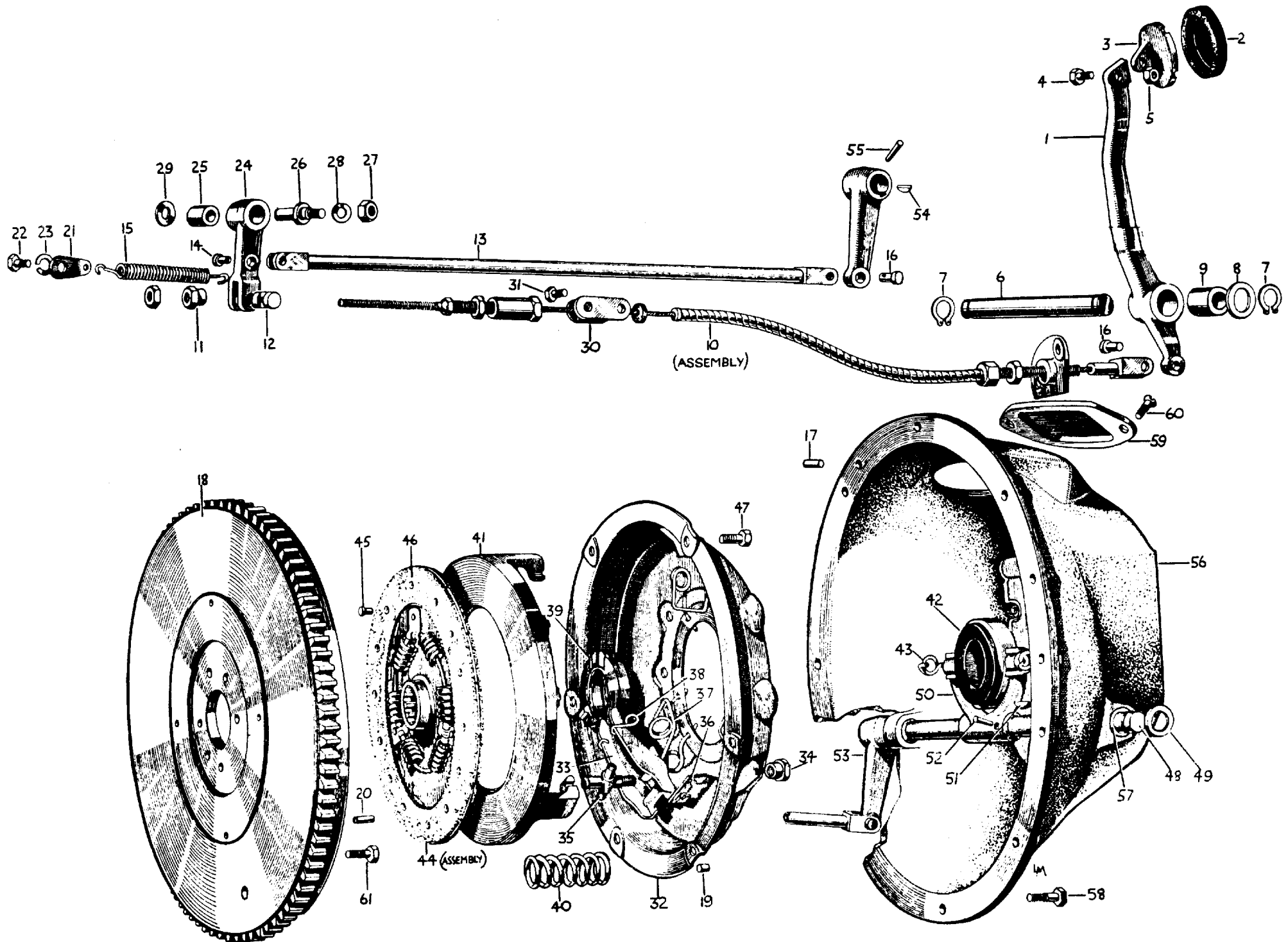

KEY TO PLATE K

Illus. No.	Description	Page No.
K1	Stud—water pump—short	F.2
K2	Stud—water pump—long	F.2
K3	Water pump body	G.3
K4	Spindle—water pump	G.3
K5	Rotor—water pump.....	G.3
K6	Taper pin—rotor	G.3
K7	Nut—spindle	G.3
K8	Washer—spindle	G.3
K9	Fan pulley	G.3
K10	Key—pulley.....	G.3
K11	Grease nipple	G.3
K12	Dust excluder—front	G.3
K13	Cover—front dust excluder	G.3
K14	Bearing—spindle	G.3
K15	Circlip—bearing	G.3
K16	Distance tube—bearing	G.3
K17	Dust excluder—rear—felt	G.3
K18	Cover—dust excluder—centre	G.3
K19	Cover—dust excluder—rear	G.3
K20	Circlip—spindle	G.3

Illus. No.	Description	Page No.
K21	Seal—water pump	G.3
K22	Joint—pump body to block	G.3
K23	Bolt—pump—short	G.3
K24	Nut—water pump bolt	G.3
K25	Bolt—pump—long	G.4
K26	Fan blade	G.4
K27	Fan blade (offset)	G.4
K28	Bolt—fan blade	G.4
K29	Distance-piece	G.4
K30	Drive belt—for fan and dynamo	G.4
K31	Connecting pipe—pump	G.4
K32	Hose—connecting pipe	G.4
K33	Clip (1½" dia.)—connecting pipe	G.4
K34	Thermostat	G.4
K35	Joint—thermostat	G.4
K36	Hose—by-pass pipe	G.4
K37	Clip (1½" dia.)—by-pass hose	G.4
K38	Elbow—thermostat	G.4
K39	Screw—elbow	G.4

THE  MIDGET (SERIES "TD")
FAN AND WATER PUMP

PLATE K

SERVICE PARTS LIST

