

SECTION H



CLUTCH DETAILS

GEARBOX

DESCRIPTION	No. off per Car	Commencing Engine No. XPAG/TD501		Part No.	Commencing Engine No.	Part No.	Commencing Engine No.	REMARKS
		Part No.	Illus. No.					
CLUTCH DETAILS								
Clutch assembly complete	1	N.S.P.						
Clutch cover assembly	1	SA2447		SA2447/1	9408			
Cover—clutch	1	7H3080	H32	7H3071				
Release lever—clutch	3	X22817	H33	7H3073	15861			
Eyebolt	3	168634	H34	7H3197				
Nut—eyebolt	3	7H3193		CA880	15861			
Fulcrum pin—release lever	3	7H3061	H35	7H3067	9408			
Strut—release lever	3	7H3060	H36	7H3069				
Spring—anti-rattle—release lever	3	7H3008	H37	7H3171	9408			
Spring—retaining—release lever	3	7H3218	H38	7H3001				
Plate—release lever	1	7H3213	H39		9408			
Spring—pressure plate	6	7H3146	H40	7H3140				
Pressure plate—clutch	1	7H3057	H41	7H3085				
Clutch release bearing and cup assembly	1	7H3214	H42					
Retainer—clutch release bearing	2	7H3185	H43					
Clutch driven plate assembly (R)	1	SA2446	H44	7H3215	9408			
Rivet—clutch driven plate	16	7H3078	H45					
Facing kit	1 set	7H3246	H46	7H3065	9408	7H3216	15861	
Bolt—clutch cover	6	CA1122	H47					
Spring washer—clutch cover	6	CA1283						
Clutch withdrawal shaft	1	X24482	H48	168023	9408			
Circlip—withdrawal shaft	1	X31399	H49	X19257				
Fork—clutch	1	X22829	H50	X19255	9408			
Key—clutch fork	1	JA5255	H51	CA1005				
Taper pin—clutch fork	1	MA3678	H52		9408			
Clutch operating lever	1	X24201	H53	168021				
Spring washer	1	7282						
Key—clutch lever	1	JA5255	H54	CA1005				
Taper pin—clutch lever	1	MA3678	H55					
AMENDMENTS								
GEARBOX DETAILS								
Gearbox assembly	1	SA2906/9		AEB3027	9408	AEB3028	16482	
Clutch housing (with bushes)	1	SA2239/3	H56	SA2239/4	9408			
Bush—clutch housing	2	X19325	H57	X20268				
Bolt securing clutch housing	10	JA5052	H58					
Spring washer—clutch housing	10	CA1283						
Clutch inspection cover	1	X19288	H59					
Screw—inspection cover	2	X22043	H60					
Gearbox casing (with studs)	1	SA2424/1	G7					
Stud—gearbox top cover	6	CB1717	G8					
Stud—speedometer casing (medium)	3	JB5968	G9					
Stud—speedometer casing (long)	1	X20505	G10					
Stud—speedometer casing (short)	2	CB1717	G11					
Plug—oil drain	1	CA1215	G12					
Washer—drain plug	1	6K432	G13					
Circlip—drain plug	1	X15868						
Bolt—gearbox to clutch housing	8	JA5052						
Spring washer—clutch housing	8	LA7281						
Oil level indicator	1	X24215	G14					
Mainshaft	1	X24467	G15	168209	16978			
Mainshaft bearing	1	AEF137	G16					
Circlip—mainshaft bearing	1	X22626	G17					

DESCRIPTION	No. off per Car	Commencing Engine No. XPAG/TD501		Part No.	Commencing Engine No.	Part No.	Commencing Engine No.	REMARKS
		Part No.	Illus. No.					
Gearbox Details—continued								
Guard—bearing—1st motion shaft	1	X22885	G18					
Plate—guard	1	X17080	G19					
Spring plate—guard	1	X17266	G20					
Striking dog	1	X24465	G21	X24245	6533			
Sliding hub assembly (top and 3rd), with cone	1	SA2435/1	G22					Fin. at 6532
Spring—sliding hub	6	X24248	G23					
Ball—spring	6	BLS110	G24					
Sliding hub assembly (top and 3rd), with cone	1		G22	SA2435/2	6533			
Spring—sliding hub	6		G23	X24248				
Ball—spring	7		G24	BLS110				
3rd speed gear	1	X24249	G25					
Rollers—3rd speed gear	32	MA3839	G26					
Collar—3rd speed gear	1	X17313	G27					
Plunger—3rd speed gear	1	AEC3181	G28					
Spring—plunger	1	AEC3182	G29					
2nd speed gear	1	X24250	G30					
Rollers—2nd speed gear	28	MA3839	G31					
Washer—2nd speed gear	2	X22634	G32					
Collar—2nd speed gear	1	X22635	G33					
Plunger—2nd speed gear	1	AEC3181	G34					
Spring plunger	1	AEC3182	G35					
Sliding hub (1st and 2nd) with cone	1	SA2434/1	G36					
1st speed gear	1	X24251	G37					
Spring—1st speed gear	6	AEC3179	G38					
Ball—spring	6	BLS110	G39					
Circlip	1	X22639	G40					
Distance piece	1	X22886	G41					
Layshaft	1	X35020	G42					
Gear unit—layshaft	1	X24216	G43					
Rollers—layshaft gear unit	28	X22377	G44					
Spacer—layshaft gear unit	1	X25015	G45					
Washer—layshaft	2	X22378	G46					
Thrust washer—front	1	X24111	G47					
Thrust washer—rear	1	X24112	G48					
Bearing plate—front	1	X24109	G49					
Bearing plate—rear	1	X24110	G50					
Screw	1	X22644	G51					
Spring washer	1	CA1282						
1st motion shaft	1	X24254	G52					
Bearing—1st motion shaft	1	AEF135	G53					
Circlip—1st motion shaft	1	X22649	G54					
Guard—bearing (1st motion shaft)	1	X22362	G55					
Nut—1st motion shaft bearing	1	X22650	G56					
Lock washer—bearing	1	X22651	G57					
Spigot bearing rollers	18	6K892	G58					
Oil seal—1st motion shaft	1	X22653	G59					
Reverse gear (with bush)	1	SA2256	G60					
Bush—reverse gear	1	X17342						
Shaft—reverse gear	1	X17343	G61					
Plug—reverse shaft	1	LA7395	G62					
Screw—reverse shaft	1	X22655	G63					
Spring washer—reverse shaft	1	CA1283						

DESCRIPTION	No. off per Car	Commencing Engine No. XPAG/TD501		Part No.	Commencing Engine No.	Part No.	Commencing Engine No.	REMARKS
		Part No.	Illus. No.					
Gearbox Details—continued								
Selector mechanism								
Top and 3rd gear selector	1	SA2273	G64					
Locating screw—selector	1	MA3641	G65					
Top and 3rd gear shifter	1	X22657	G66					
Locating screw—shifter	1	MA3641	G67					
Distance tube—top and 3rd	1	X22848	G68					
Shaft—top and 3rd shifter assembly	1	SA2402/3	G69	SA2402/5	16482			
Shaft—top and 3rd shifter	1	X24457		168223	16482			
Pin for shaft	1	AEC3187						
Rivet for shaft	1	AEC3188						
Circlip—shaft	1	X24377	G131					
1st and 2nd gear shifter	1	X22889	G70					
Locating screw	1	MA3641	G71					
1st and 2nd gear selector	1	X22890	G72					
Locating screw	1	MA3641	G73					
Shaft—1st and 2nd shifter	1	X24449	G74					
Stop—shaft	1	X22851	G75					
Locating screw—stop	1	MA3641	G76					
Reverse gear selector	1	X22893	G77					
Plunger—reverse gear selector	1	X17186	G78					
Spring—plunger	1	AEG3107	G79					
Ball—reverse plunger	1	BLS110	G80					
Spring—ball	1	AEG3102	G81					
Locating screw	1	MA3641	G82					
Shaft—reverse selector	1	X24369	G83					
Steady—reverse selector shaft	1	X22850	G84					
Locating screw steady	1	MA3641	G85					
Gear shifter reverse—upper	1	X22892	G86					
Locating screw for shifter	1	MA3641	G85					
Gear shifter reverse—lower	1	X24259	G87					
Shaft—reverse gear shifter	1	X22665	G88					
Locating screw—shaft	1	X15141	G89					
Spring washer	1	CA1282						
Reverse gear link assembly	1	SA2272	G90					
Fulcrum pin link	1	X17350	G91					
Nut—fulcrum pin	1	JA5088	G92					
Washer—fulcrum pin	1	X15176	G93					
Ball—shifter shaft	5	BLS110	G94					
Spring—shifter shaft	3	AEC3189	G95					
Plug—ball hole (in gearbox casing)	1	MA3650						
Gearbox cover	1	X22895	G96					
Gasket—cover	1	X22671	G97					
Nut—cover	6	CA1126	G98					
Spring washer—cover nut	6	CA1283						
Filler plug—gearbox	1	SA1340	G99					
Washer for plug	1	163422	G100					
Rear casing	1	X24220	G101					
Gasket for rear casing	1	X22736						
Nut—rear casing	6	CA1126	G102					
Spring washer—casing nut	6	CA1283						
Ball bearing	1	97H551	G103					
Guard	1	X19171	G104					
Oil retaining washer	1	X19147	G105					
Hole plug—reverse light	1	AEG385	G106					
Speedometer gear	1	X22900	G107	168210	16978			

KEY TO PLATE G

Illus. No.	Description	Page No.
G1	Rear engine bearer bracket	F.2
G2	Support rubber	F.2
G3	Fork end	F.2
G4	Engine rebound rubber.....	F.2
G5	Clevis pin—fork end	F.2
G6	Washer	F.2
G7	Gearbox casing (with studs)	H.2
G8	Stud—gearbox top cover	H.2
G9	Stud—speedometer casing—medium	H.2
G10	Stud—speedometer casing—long	H.2
G11	Stud—speedometer casing—short	H.2
G12	Plug—oil drain	H.2
G13	Washer—drain plug	H.2
G14	Oil level indicator	H.2
G15	Mainshaft	H.2
G16	Mainshaft bearing	H.2
G17	Circlip—mainshaft bearing	H.2
G18	Guard—bearing—first motion shaft	H.3
G19	Plate guard	H.3
G20	Spring plate—guard	H.3
G21	Striking dog	H.3
G22	Sliding hub assembly (top and third)	H.3
G23	Spring—sliding hub	H.3
G24	Ball—spring	H.3
G25	Thrd speed gear	H.3
G26	Rollers—third speed gear	H.3
G27	Collar—third speed gear	H.3
G28	Plunger—third speed gear	H.3
G29	Spring—plunger	H.3
G30	Second speed gear	H.3
G31	Rollers—second speed gear	H.3
G32	Washer—second speed gear	H.3
G33	Collar—second speed gear	H.3
G34	Plunger—second speed gear	H.3
G35	Spring plunger	H.3
G36	Sliding hub (first and second)	H.3
G37	First speed gear	H.3
G38	Spring—first speed gear	H.3
G39	Ball—spring	H.3
G40	Circlip	H.3
G41	Distance-piece	H.3
G42	Layshaft	H.3
G43	Gear unit—layshaft	H.3
G44	Rollers—layshaft gear unit	H.3
G45	Spacer—layshaft gear unit.....	H.3
G46	Washer—layshaft	H.3
G47	Thrust washer—front	H.3
G48	Thrust washer—rear	H.3
G49	Bearing plate—front	H.3
G50	Bearing plate—rear	H.3
G51	Screw	H.3
G52	First motion shaft	H.3
G53	Bearing—first motion shaft	H.3
G54	Circlip—first motion shaft	H.3
G55	Guard—bearing—first motion shaft	H.3
G56	Nut—first motion shaft bearing	H.3
G57	Lock washer—bearing	H.3
G58	Spigot bearing rollers	H.3
G59	Oil seal—first motion shaft	H.3
G60	Reverse gear (with bush)	H.3
G61	Shaft—reverse gear	H.3
G62	Plug—reverse shaft	H.3
G63	Screw—reverse shaft	H.3
G64	Top and third gear selector	H.3
G65	Locating screw—selector.....	H.3
G66	Top and third gear shifter	H.3

Illus. No.	Description	Page No.
G67	Locating screw—shifter	H.3
G68	Distance tube—top and third	H.4
G69	Shaft—top and third shifter	H.4
G70	First and second gear shifter	H.4
G71	Locating screw	H.4
G72	First and second gear selector	H.4
G73	Locating screw	H.4
G74	Shaft—first and second shifter	H.4
G75	Stop—shaft	H.4
G76	Locating screw—stop	H.4
G77	Reverse gear selector	H.4
G78	Plunger—reverse gear selector	H.4
G79	Spring—plunger	H.4
G80	Ball—reverse plunger	H.4
G81	Spring—ball	H.4
G82	Locating screw	H.4
G83	Shaft—reverse selector	H.4
G84	Steady—reverse selector shaft.....	H.4
G85	Locating screw—steady	H.4
G86	Gear shifter reverse—upper	H.4
G87	Gear shifter reverse—lower	H.4
G88	Shaft—reverse gear shifter.....	H.4
G89	Locating screw—shaft	H.4
G90	Reverse link assembly	H.4
G91	Fulcrum pin—link	H.4
G92	Nut—fulcrum pin.....	H.4
G93	Washer—fulcrum pin	H.4
G94	Ball—shaft	H.4
G95	Spring—shifter shaft	H.4
G96	Gearbox cover.....	H.4
G97	Gasket—cover	H.4
G98	Nut—cover	H.4
G99	Filler plug—gearbox	H.4
G100	Washer for plug	H.4
G101	Rear casing	H.4
G102	Nut—rear casing	H.4
G103	Ball bearing	H.4
G104	Guard	H.4
G105	Oil retaining washer	H.4
G106	Hole plug—reverse light.....	H.4
G107	Speedometer gear	H.4
G108	Speedometer pinion	H.4
G109	Bearing—pinion	H.4
G110	Screw—pinion bearing	H.4
G111	Flange—universal joint	H.4
G112	Washer—flange	H.4
G113	Nut—flange to mainshaft.....	H.4
G114	Remote control cover	H.4
G115	Gasket—cover	H.5
G116	Cover bolt to rear casing.....	H.5
G117	Housing cover plunger	H.5
G118	Plug—operating shaft	H.5
G119	Spring—operating shaft	H.5
G120	Remote control shaft	H.5
G121	Selector lever—front	H.5
G122	Selector lever—rear	H.5
G123	Ball—lever	H.5
G124	Key—actuating shaft and selector levers	H.5
G125	Bolt—actuating shaft and selector levers	H.5
G126	Change speed lever	H.5
G127	Knob—change speed lever	H.5
G128	Cover—lever	H.5
G129	Spring—anti-rattle change speed lever	H.5
G130	Circlip—cover	H.5
G131	Circlip—shaft.....	H.4

THE  MIDGET (SERIES "TD"),

GEARBOX

PLATE G

SERVICE PARTS LIST

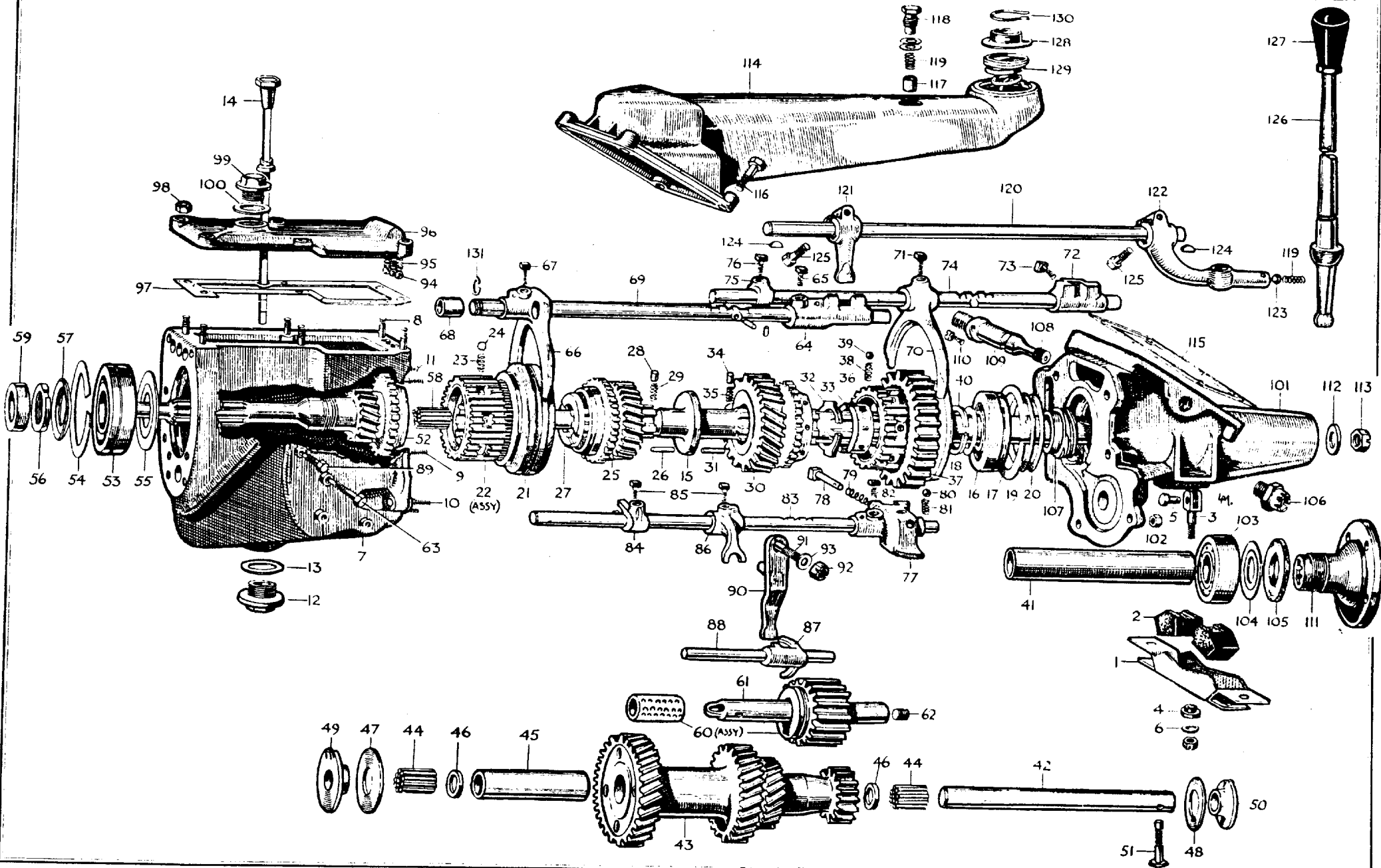

KEY TO PLATE H

Illus. No.	Description	Page No.
H1	Clutch pedal and bush	D.2
H2	Pad—rubber—clutch pedal	D.2
H3	Pad—brake pedal.....	D.2
H4	Bolt—pad—brake pedal	D.2
H5	Nut—pad bolt	D.2
H6	Shaft—clutch.....	D.2
H7	Seager circlip.....	D.2
H8	Spacing washer between pedals	D.2
H9	Bush—brake pedal.....	D.2
H10	Clutch cable assembly.....	D.2
H11	Nut—clutch adjuster	D.2
H12	Pin—clutch adjuster	D.2
H13	Connecting rod—clutch	D.2
H14	Yoke pin—rod	D.2
H15	Spring—clutch return	D.2
H16	Pin—clutch lever	D.2
H17	Dowel—clutch housing	F.2
H18	Flywheel (with starter ring and dowels)	F.4
H19	Dowel—clutch cover	F.4
H20	Dowel—crankshaft	F.4
H21	Bracket—clutch return spring.....	G.2
H22	Bolt—bracket	G.2
H23	Spring washer—bolt	G.2
H24	Lever—cable and connecting rod	G.2
H25	Bush—lever	G.2
H26	Fulcrum pin—lever	G.2
H27	Nut—fulcrum pin.....	G.2
H28	Washer—fulcrum pin	G.2
H29	Washer—fulcrum pin—outer	G.2
H30	Abutment bracket—clutch cable	G.2
H31	Bolt—bracket	G.2

Illus. No.	Description	Page No.
H32	Cover—clutch	H.2
H33	Release lever—clutch	H.2
H34	Eye-bolt and nut	H.2
H35	Fulcrum pin—release lever	H.2
H36	Strut—release lever	H.2
H37	Spring—anti-rattle—release lever	H.2
H38	Spring—retaining—release lever	H.2
H39	Plate—release lever	H.2
H40	Spring—pressure plate	H.2
H41	Pressure plate—clutch.....	H.2
H42	Clutch release bearing and cup assembly ..	H.2
H43	Retainer—clutch release bearing	H.2
H44	Clutch driven plate assembly	H.2
H45	Rivet—clutch driven plate	H.2
H46	Facing	H.2
H47	Bolt—clutch cover	H.2
H48	Clutch withdrawal shaft	H.2
H49	Circlip—withdrawal shaft	H.2
H50	Fork—clutch	H.2
H51	Key—clutch fork	H.2
H52	Taper pin—clutch fork	H.2
H53	Clutch operating lever	H.2
H54	Key—clutch lever	H.2
H55	Taper pin—clutch lever	H.2
H56	Clutch housing (with bushes)	H.2
H57	Bush—clutch housing	H.2
H58	Bolt—securing clutch housing	H.2
H59	Clutch inspection cover	H.2
H60	Screw—inspection cover	H.2
H61	Bolt—flywheel securing.....	H.4

